

**Friday 18 January 2013 – Afternoon**

**AS GCE HEALTH AND SOCIAL CARE**

**F913/01** Health and Safety in Care Settings

Candidates answer on the Question Paper.

**OCR supplied materials:**

None

**Other materials required:**

None

**Duration:** 1 hour 30 minutes



Candidate forename		Candidate surname	
-----------------------	--	----------------------	--

Centre number						Candidate number				
---------------	--	--	--	--	--	------------------	--	--	--	--

**INSTRUCTIONS TO CANDIDATES**

- Write your name, centre number and candidate number in the boxes above. Please write clearly and in capital letters.
- Use black ink. HB pencil may be used for graphs and diagrams only.
- Answer **all** the questions.
- Read each question carefully. Make sure you know what you have to do before starting your answer.
- Write your answer to each question in the space provided. If additional space is required, you should use the lined pages at the end of this booklet. The question number(s) must be clearly shown.
- Do **not** write in the bar codes.

**INFORMATION FOR CANDIDATES**

- The number of marks is given in brackets [ ] at the end of each question or part question.
- The total number of marks for this paper is **100**.
- You will be awarded marks for the quality of written communication where an answer requires a piece of extended writing.
- This document consists of **20** pages. Any blank pages are indicated.

1



A

2



B



C

(a) The warning signs shown above may be found in a hospital.

Identify each sign.

State where in a hospital each is likely to be found.

State how each warning should improve safety in that area.

**A** .....

.....

.....

.....

.....

.....

**B** .....

.....

.....

.....

.....

.....

**C** .....

.....

.....

.....

.....

..... [9]





(b) Identify **four** pieces of information which should be included in an accident report. Give **one** different reason why each piece of information is necessary.

1 .....

.....

.....

.....

.....

2 .....

.....

.....

.....

.....

3 .....

.....

.....

.....

.....

4 .....

.....

.....

.....

.....

[8]

3 (a) State the **five** stages of risk assessment in the correct order.

- 1 .....
- 2 .....
- 3 .....
- 4 .....
- 5 ..... [5]

**Plan of a childminder's home**

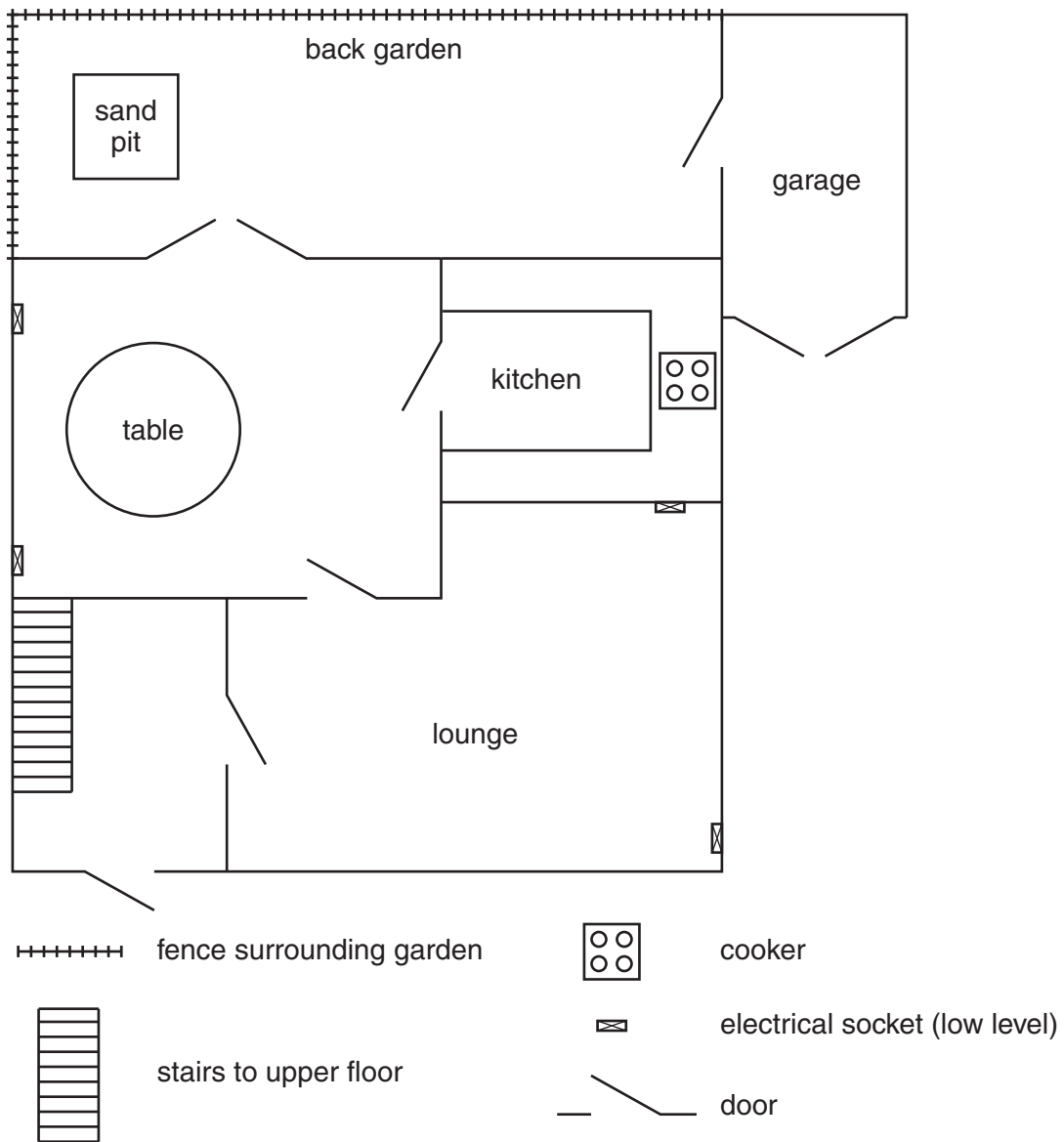







**BLANK PAGE**

**Question 4 begins on page 10**

**PLEASE DO NOT WRITE ON THIS PAGE**













**ADDITIONAL ANSWER SPACE**

If additional answer space is required, you should use the following lined page(s). The question number(s) must be clearly shown in the margins.

This section of the page is a large, empty area of lined paper. It features a vertical solid line on the left side, creating a margin. The rest of the page is filled with horizontal dotted lines, providing space for students to write their answers. The lines are evenly spaced and extend across the width of the page.



A vertical line is positioned on the left side of the page. To its right, there are 25 horizontal dotted lines, evenly spaced, extending across the width of the page. This layout is typical for a handwriting practice sheet or a notebook page.

A vertical solid line is positioned on the left side of the page. From this line, 25 horizontal dotted lines extend across the page, creating a series of rows for writing.

A vertical solid line is positioned on the left side of the page. From this line, 25 horizontal dotted lines extend across the page, creating a series of rows for writing.

**PLEASE DO NOT WRITE ON THIS PAGE**



**Copyright Information**

OCR is committed to seeking permission to reproduce all third-party content that it uses in its assessment materials. OCR has attempted to identify and contact all copyright holders whose work is used in this paper. To avoid the issue of disclosure of answer-related information to candidates, all copyright acknowledgements are reproduced in the OCR Copyright Acknowledgements Booklet. This is produced for each series of examinations and is freely available to download from our public website ([www.ocr.org.uk](http://www.ocr.org.uk)) after the live examination series.

If OCR has unwittingly failed to correctly acknowledge or clear any third-party content in this assessment material, OCR will be happy to correct its mistake at the earliest possible opportunity.

For queries or further information please contact the Copyright Team, First Floor, 9 Hills Road, Cambridge CB2 1GE.

OCR is part of the Cambridge Assessment Group; Cambridge Assessment is the brand name of University of Cambridge Local Examinations Syndicate (UCLES), which is itself a department of the University of Cambridge.