

ADVANCED SUBSIDIARY GCE
HEALTH AND SOCIAL CARE
Unit 4: Health and Safety in Care Settings

F913

Candidates answer on the Question Paper

OCR Supplied Materials:

None

Other Materials Required:

None

Friday 21 May 2010
Morning

Duration: 1 hour 30 minutes



Candidate Forename		Candidate Surname	
--------------------	--	-------------------	--

Centre Number						Candidate Number				
---------------	--	--	--	--	--	------------------	--	--	--	--

INSTRUCTIONS TO CANDIDATES

- Write your name clearly in capital letters, your Centre Number and Candidate Number in the boxes above.
- Use black ink. Pencil may be used for graphs and diagrams only.
- Read each question carefully and make sure that you know what you have to do before starting your answer.
- Answer **all** the questions.
- Do **not** write in the bar codes.
- Write your answer to each question in the space provided. If additional space is required, you should use the lined pages at the end of this booklet. The question number(s) must be clearly shown.

INFORMATION FOR CANDIDATES

- The number of marks is given in brackets [] at the end of each question or part question.
- The total number of marks for this paper is **100**.
- You will be awarded marks for the quality of written communication where an answer requires a piece of extended writing.
- This document consists of **20** pages. Any blank pages are indicated.

1 (a) Identify each of the safety signs shown below. For each one describe how it reduces risk.

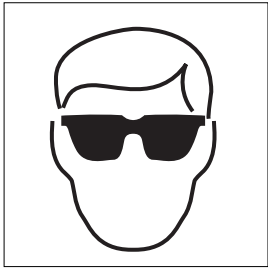

A



B



C

A

.....

.....

.....

B

.....

.....

.....

C

.....

.....

..... [6]

(b) Complete the table below to show how different types of sign can be recognised by their design.

Type of sign	Background colour	Shape of sign
Caution / risk of danger
Stop / Prohibition
Safe condition
Mandatory action (must do)

[8]

(c) Identify the legislation that governs the use of safety signs (date not required).

..... [1]

[Total: 15]

2 (a) Identify **two** pieces of information that must be added by the employer to the Health and Safety Law poster in a care setting.

1

.....

2

..... [2]

(b) (i) Identify the organisation that is responsible for enforcing Health and Safety law.
..... [1]

(ii) Give **one** other function of this organisation.
.....

..... [1]

(c) Identify **four** pieces of information that must be included in an accident report.

1

.....

2

.....

3

.....

4

..... [4]

(d) What is meant by the term 'cross infection'?

.....

.....

..... [1]

(e) Identify **three** ways practitioners can help to prevent cross infection in a care setting.

For each one explain how the risk of cross infection is prevented or reduced.

1

.....

.....

.....

2

.....

.....

.....

3

.....

.....

.....

[6]

[Total: 15]

Hospital Outpatients Department

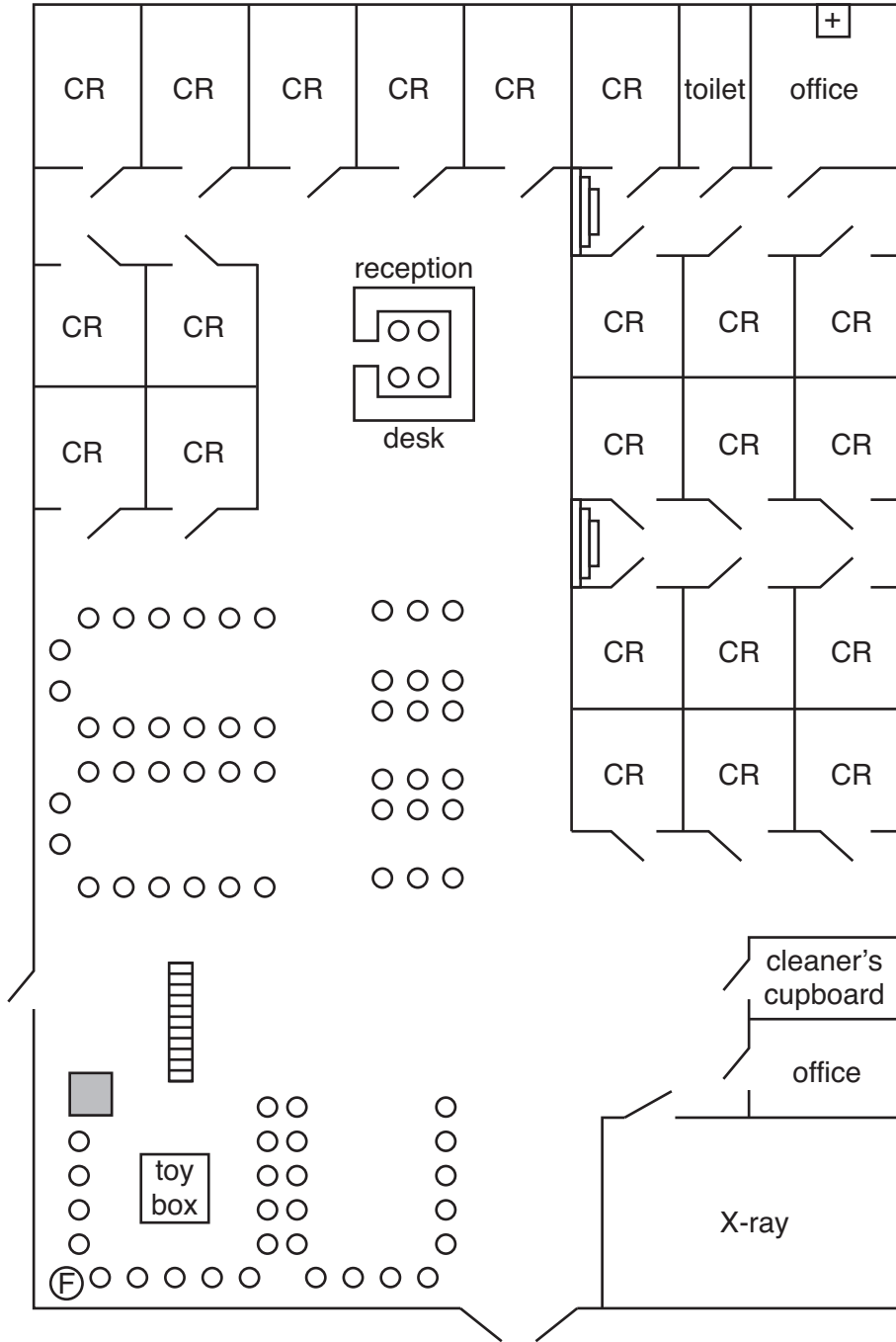

Key:

- CR consulting room
- ⓕ fire extinguisher
- ⊕ first aid box
- ▭ stairs

- ▤ leaflet stand
- chair
- hot drinks machine
- door opening

.....
.....
.....
.....
.....
.....
.....
.....
.....
.....
.....
.....
.....
.....
.....
.....
.....
.....
.....

[15]

(b) The fifth stage of risk assessment is to review the risk assessment. Analyse the importance of this stage.

.....
.....
.....
.....
.....
.....
.....
.....
.....
.....
.....
.....
.....
.....
.....
.....
.....
.....

[5]

[Total: 20]

BLANK PAGE

PLEASE DO NOT WRITE ON THIS PAGE

4 (a) Identify **one** piece of equipment that could be used by a practitioner to move an individual.

..... [1]

(b) Name **one** piece of legislation that controls the use of equipment used for moving individuals (date not required).

..... [1]

(c) Suggest **four** points that you would expect to find on a checklist to be used before moving or handling an individual. For each one give an explanation of why it should be included.

1

.....

.....

.....

2

.....

.....

.....

3

.....

.....

.....

4

.....

.....

..... [8]

(c) Outline the key features of COSHH (Control of Substances Hazardous to Health) regulations.

.....
.....
.....
.....
.....
.....
.....
.....
.....
.....
.....
.....
.....

[5]

(d) Identify **two** specific substances likely to be found in a care setting which are governed by COSHH regulations.

1

2 [2]

[Total: 15]

6 (a) Identify **four** pieces of equipment found in care settings that could increase the time available for evacuation in the event of fire. For each piece of equipment explain how it achieves this benefit.

1

.....

.....

.....

2

.....

.....

.....

3

.....

.....

.....

4

.....

.....

.....

[8]

A series of 25 horizontal dotted lines spanning the width of the page, intended for handwriting practice.



Copyright Information

OCR is committed to seeking permission to reproduce all third-party content that it uses in its assessment materials. OCR has attempted to identify and contact all copyright holders whose work is used in this paper. To avoid the issue of disclosure of answer-related information to candidates, all copyright acknowledgements are reproduced in the OCR Copyright Acknowledgements Booklet. This is produced for each series of examinations, is given to all schools that receive assessment material and is freely available to download from our public website (www.ocr.org.uk) after the live examination series.

If OCR has unwittingly failed to correctly acknowledge or clear any third-party content in this assessment material, OCR will be happy to correct its mistake at the earliest possible opportunity.

For queries or further information please contact the Copyright Team, First Floor, 9 Hills Road, Cambridge CB2 1GE.

OCR is part of the Cambridge Assessment Group; Cambridge Assessment is the brand name of University of Cambridge Local Examinations Syndicate (UCLES), which is itself a department of the University of Cambridge.